

700
SIX

LEED PLATINUM CERTIFIED



Akridge
Real Estate at the Highest Grade

601 THIRTEENTH STREET, NW
SUITE 300 NORTH
WASHINGTON, DC 20005

WWW.700SIXTHSTREET.COM

NEIGHBORHOOD

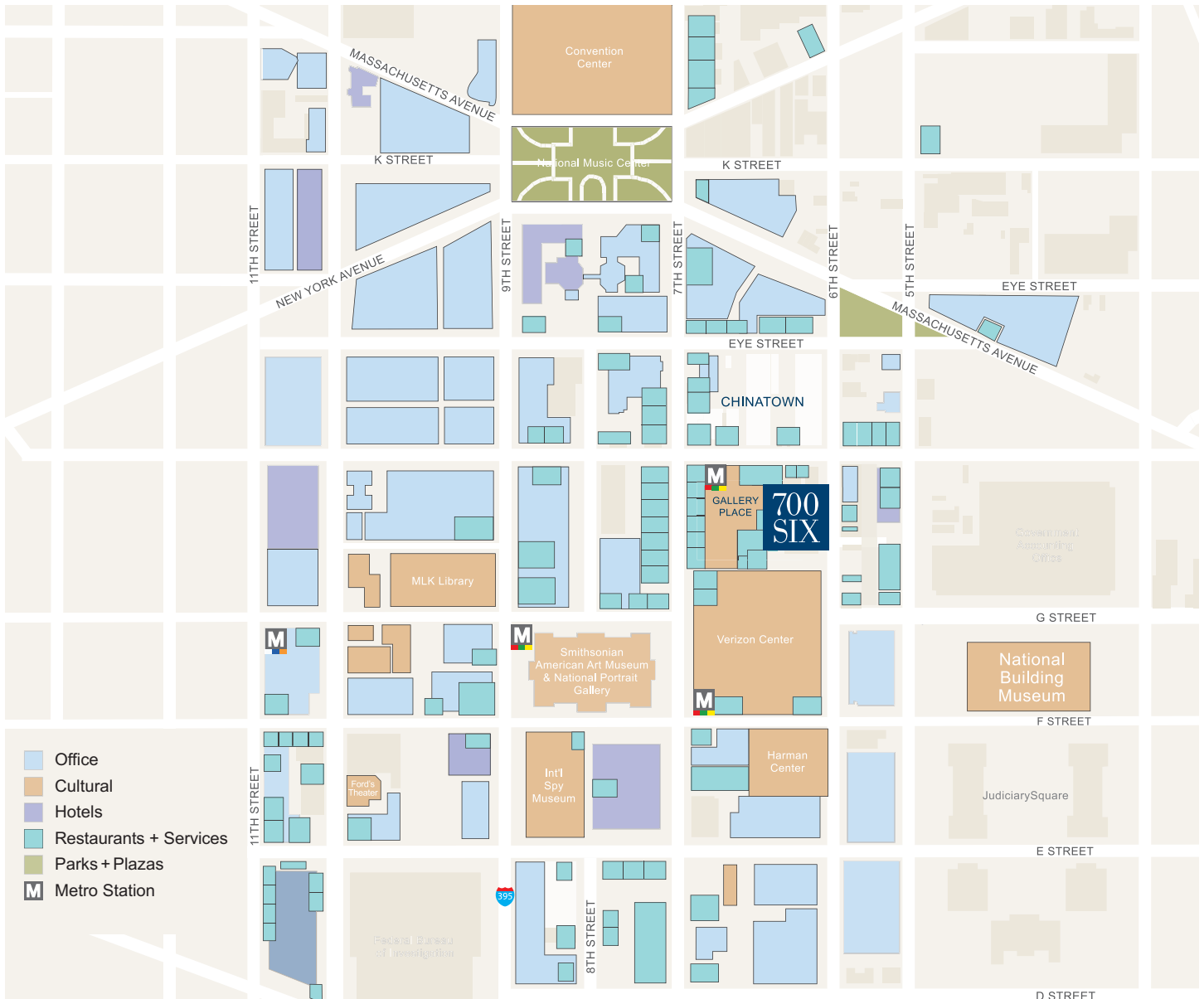

700
SIX

LOBBY VIEW #1



700
SIX

LOBBY VIEW #2



700
SIX

ROOFTOP VIEW



Akridge
Real Estate at the Highest Grade

601 THIRTEENTH STREET, NW
SUITE 300 NORTH
WASHINGTON, DC 20005

WWW.700SIXTHSTREET.COM

700
SIX

CONCOURSE

5,214 SQUARE FEET AVAILABLE

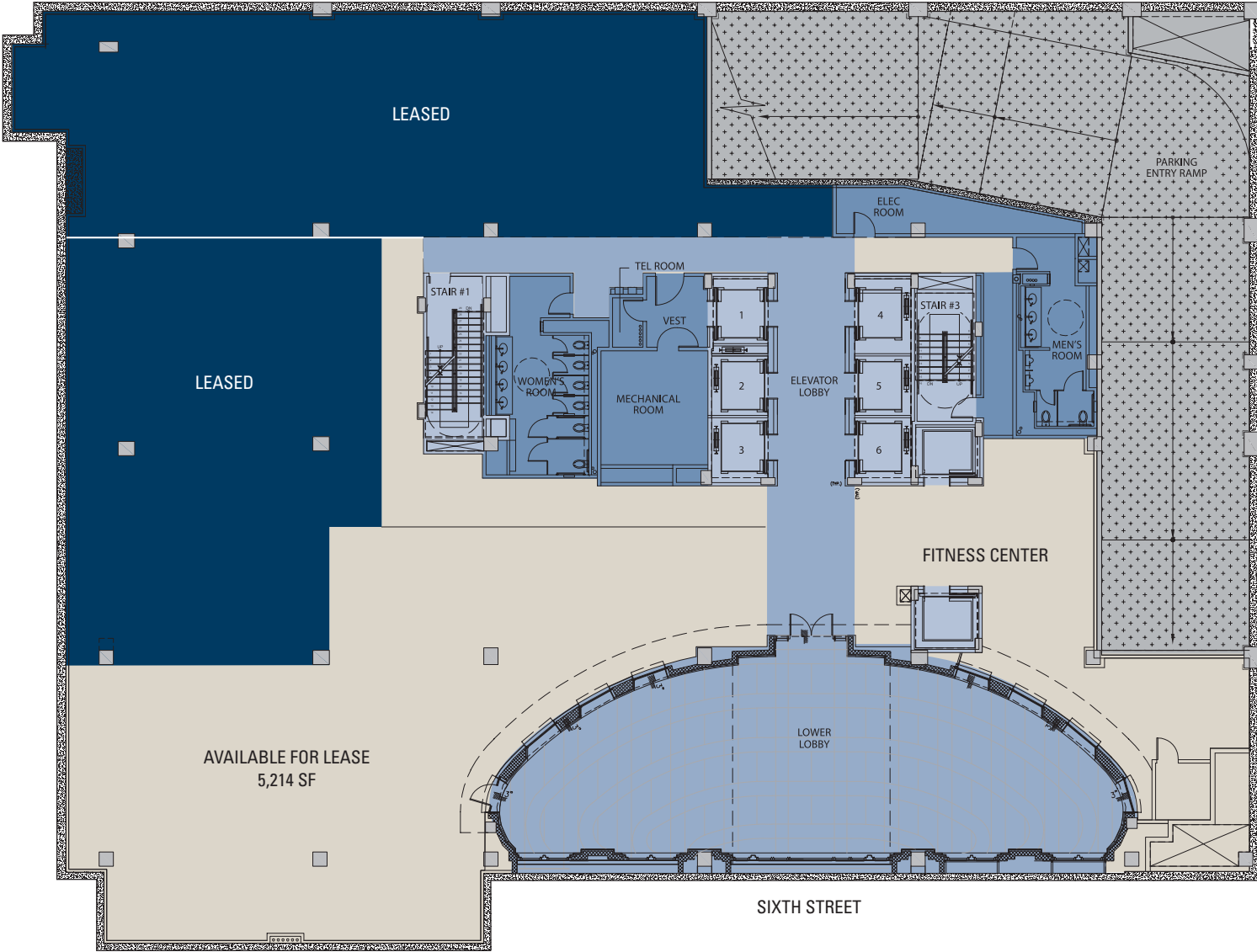

BUILDING SPECIFICATIONS

BUILDING SIZE

- Building height: 12 stories
- Total rentable area: 300,487 SF (6,677 SF on ground floor for retail or office and 10,571 SF of concourse level space)
- Typical floor: 26,100 SF

BUILDING FEATURES

- Virtually free standing building with upper-floor windows on all four sides
- Classic architectural design by HOK
- Voice/data—fiber optics and T1
- Floor load—80 lbs. live load, 25 lbs. dead load—typical floors
- Electric power—2.5 watts per square foot for lighting; 6.0 watts per square foot for power receptacles
- HVAC—variable air volume system
- 1 space per 1,700 SF in 3-level secure parking garage
- Finished ceiling height of 8'6" on all office floors
- Column spacing—30' x 30'
- 6 high-speed, traction passenger elevators serving office floors
- 2 high-speed garage shuttle elevators
- State-of-the-art security system
- Reinforced concrete base building construction

FINISHES

- Glass curtain wall facade, with limestone base, stone-clad towers and metal spandrel panels
- Main lobby with marble floor, glass bridges, and metal walls; drywall ceiling and incandescent downlighting

KEY AMENITIES

- LEED Platinum certified
- In-building wireless system
- Full-service concierge
- Client-only fitness facility
- Green roof
- Rooftop terrace with Capitol Dome views
- Gallery Place retail and dining
- One block from Gallery Place Metro Station (Red, Green and Yellow lines)
- Award-winning Akridge property management services